



Are Stockists & Suppliers of:

FLOODGATE

- Awarded BSI Kitemark for flood protection for building apertures.
- Recognised by the Environmental Agency and most leading insurers.
- Provides greater flood protection than 50+ traditional sandbags without the associated costs.
- Minimal space needed for installation as only 25mm thick.
- Existing doors can be opened to allow access when installed.
- Easy to install, maintain, transport and store.

IFDP Ltd
2nd Floor Offices
16 Mere Street
Diss
Norfolk
IP22 4AD

Tel: 01379 644033
Fax: 01379 644073



THE FLOODGATE DOOR BARRIER



Front of Unit



Rear of Unit

enquiries@ifdp.co.uk **www.ifdp.co.uk**

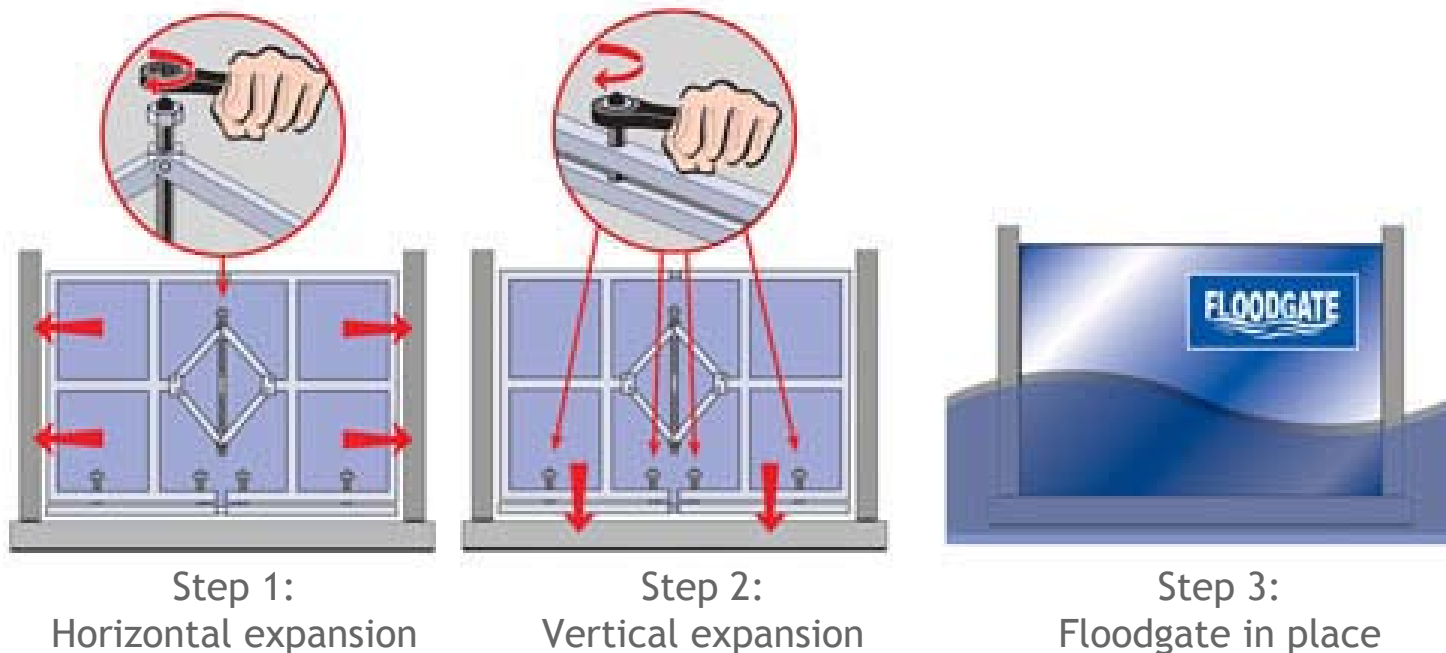

Due to its unique design, Floodgate does not require any permanent fittings to the property it is protecting, making it ideal for use on listed buildings. It takes approximately 2 minutes to install and can be installed during flooding, meaning that little or no warning is required.

Floodgate comprises of a 25mm thick, steel boxed frame which expands telescopically on the horizontal and vertical plane (see diagrams above). The frame is enveloped by a 7mm thick neoprene jacket which when expanded, forms a water-proof seal between the gate and the aperture it is expanded into.

After use:

Reduce horizontal & vertical pressure points then remove unit from position. Remove cover this can be hand or machine washed in warm water. Wipe clean then unit & lubricate the expanding mechanisms.

Available Sizes:

STANDARD

Length: 735mm - expands to 870mm
Height: 680mm
Boxed Weight: 16.45kg

MEDIUM

Length: 955mm - expands to 1175mm
Height: 680mm
Boxed Weight: 21.45kg

REGULAR

Length: 870mm - expands to 955mm
Height: 680mm
Boxed Weight: 19.00kg

LARGE

Length: 1175mm - expands to 1405mm
Height: 680mm
Boxed Weight: 23.95kg